

## LM2X-DM LED Light Source

(Product ID: LM2X-DM-400, LM2X-DM-460)

The LM2X-DM is a 2-inch, air-cooled LED light source that provides uniform, stable illumination, for Pressure and Temperature Sensitive Paint measurements. The LM2X-DM has been designed for radiometric PSP and TSP systems. The LM2X-DM can operate continuously or in a long pulsed mode. The operation mode is set using an external toggle switch. Pulsed mode operation is controlled by applying a TTL voltage to the external BNC on the DM module. In this mode, the rise time is less than 5- $\mu$ s and the fall time is less than 250- $\mu$ s and the duty cycle may be set to from 0% to 100%. The light distribution from the unit is approximately Gaussian for distance greater than 18-inches [45-cm] from the source. The units are available in 400-nm and 460-nm packages, however, other wavelenths are available upon request. The unit may be operated for radiometric or lifetime based systems by interchanging the driver module (DM module for radiometric, DMHP module for lifetime).

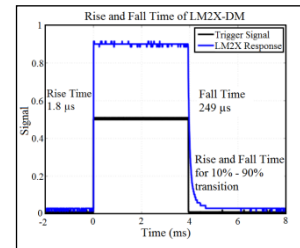
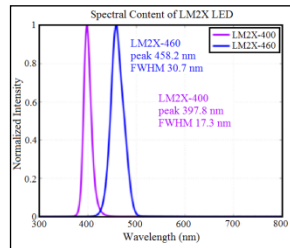
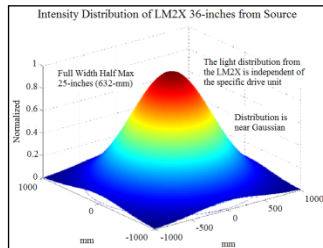
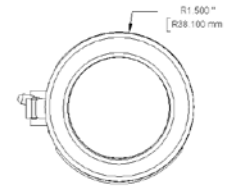
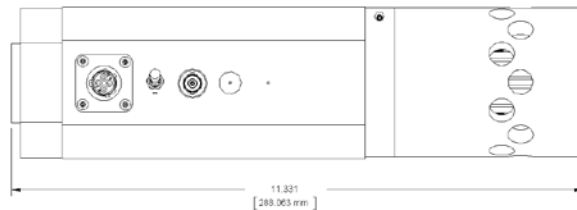

## SPECIFICATIONS

<b>Optical Power</b>	4-5 W
<b>Input</b>	48V $\text{---}$ 2.7A
<b>Stability</b>	$\sim$ 0.1 % per hour after warmup
<b>Wavelength</b>	400-nm, 460-nm
<b>Rise time (10% - 90%)</b>	< 5 $\mu$ s
<b>Fall time (90% - 10%)</b>	$\sim$ 250 $\mu$ s
<b>Maximum Duty Cycle</b>	100%
<b>Operating Temperature</b>	-10°C to 60°C
<b>FWHM</b>	+/- 18-nm
<b>ECCN</b>	EAR99

Innovative Scientific Solutions, Inc.  
7610 McEwen Road, Dayton, OH 45459  
Phone (937) 630-3012 Fax (937) 630-3015

email: [issi-sales@innssi.com](mailto:issi-sales@innssi.com)  
web: [www.psp-tsp.com](http://www.psp-tsp.com)

Any and all underlying information and technology contained in this document may be subject to U.S. export controls, including the Export Administration Act (50 U.S.C. Appx. §§ 2401 et seq.) and the Export Administration Regulations ("EAR", 50 C.F.R. Parts 730-774), and may be subject to export or import regulations in other countries. You are responsible for complying with all trade regulations and laws both foreign and domestic. Except as authorized by law or distributor agreement with ISSI, you agree and warrant not to export or re-export the information to any country, or to any person, entity, or end-user subject to U.S. export controls, including without limitation persons or entities listed on the U.S. Department of Commerce Bureau of Export Administration's Denied Parties List and the U.S. Department of Treasury's Specially Designated Nationals. You further represent and warrant that no U.S. federal agency has suspended, revoked, or denied your export privileges.